



Eastwood Road , Rayleigh SS6 7LE

- Semi-Detached House
- Approx 90ft Garden with outbuilding.
- Stunning Modern Kitchen
- Off road parking and garage
- Well Presented throughout, ready for move in.
- Four Bedrooms with an additional loft room
- Family bathroom and separate w/c
- Sought after Location in Rayleigh
 - Lounge and Dining Room
 - No Onward Chain

Guide Price £525,000 Freehold



Location





Local Authority
Council Tax Band D
EPC Rating

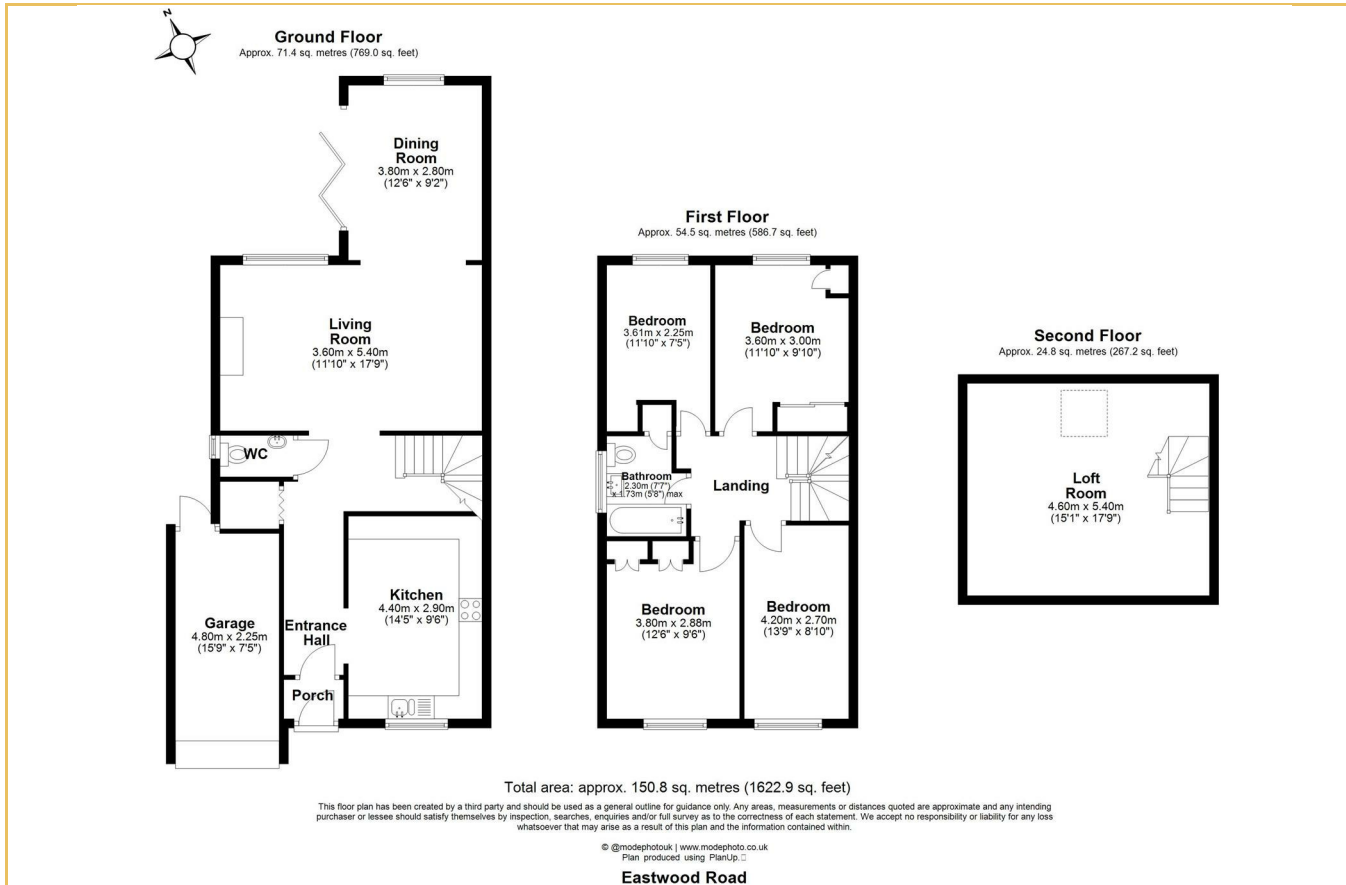

Sales Office
190 London Road
Southend-On-Sea
Essex
SS1 1PJ

Contact
01702 34 11 77
<https://hairandson.co.uk/>

Agents Note: Whilst every care has been taken to prepare these particulars, they are for guidance purposes only. All measurements are approximate and for general guidance purposes only and whilst every care has been taken to ensure accuracy, they should not be relied upon and potential buyers/tenants are advised to recheck the measurements.

