



## Valkyrie Road, Westcliff on Sea

Guide Price £136,000 Leasehold

- Tenant in situ, 8.68% yield
  - First floor flat
- One bedroom, one bathroom
  - 60 YEAR LEASE
- Close to local amenities
- Cash buyers only
- Investment opportunity
  - Low Charges
- Located in Westcliff-On-Sea
- Viewing recommended



**\*\*TENANT IN SITU\*\***

Hair & Son are pleased to present this first floor one bedroom flat here in Westcliff-On-Sea in a well situated position near Hamlet Court and all its amenities.

This property is being marketed as an investment only property, to be purchased with a tenant in Situ. The current rent that the property is achieving is £1000pcm with £200 for the yearly charges, thus giving this purchase a net rental yield of 8.68%.

The property currently has 60 years remaining on the lease, we are looking for cash buyers only with this purchase.

#### **HALLWAY**

#### **Bedroom One**

12.9 x 11.1

#### **Lounge**

13.3 x 10.5

#### **Kitchen**

10 X 7.1

#### **Bathroom**



- Tenant in situ, 8.68% yield
- Cash buyers only
- First floor flat
- Investment opportunity
- One bedroom, one bathroom
- Low Charges
- 60 YEAR LEASE
- Located in Westcliff-On-Sea
- Close to local amenities
- Viewing recommended

**\*\*TENANT IN SITU\*\* \*\*8.68% NET RENTAL YIELD\*\***

Nestled on Valkyrie Road in the charming area of Westcliff-On-Sea, this delightful one-bedroom flat presents an excellent investment opportunity. This first-floor residence is perfect for those seeking a property with a strong rental yield, boasting an impressive net yield of 8.68%.

As a cash buyers-only property, this flat is currently tenanted, making it an attractive option for investors looking to expand their portfolio. The location in Westcliff-On-Sea is particularly appealing, with its proximity to local amenities, transport links, and the beautiful coastline, ensuring a steady demand for rental properties in the area.

This flat is not just a property; it is a chance to secure a sound investment in a vibrant community. If you are looking to invest in a property with a reliable income stream, this flat on Valkyrie Road could be the perfect choice for you.

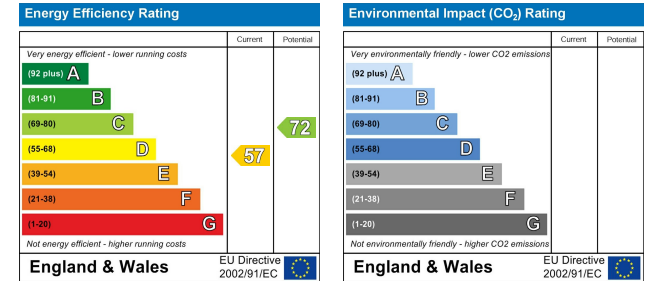

## First Floor

Approx. 41.7 sq. metres (448.3 sq. feet)

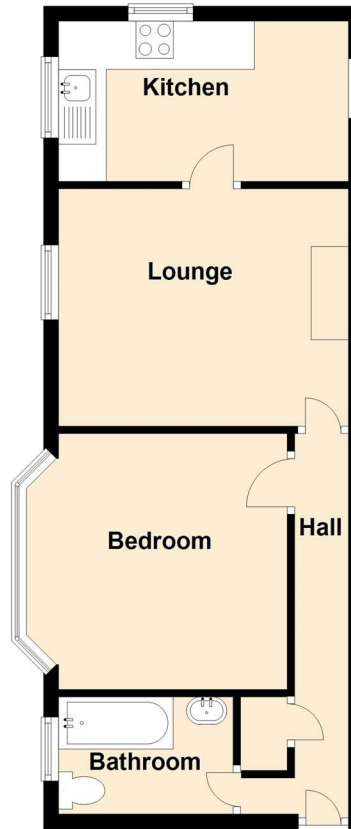

Total area: approx. 41.7 sq. metres (448.3 sq. feet)

### Sales Office

190 London Road, Southend-On-Sea,  
Essex, SS1 1PJ

### Contact

01702 34 11 77

<https://hairandson.co.uk/>

Agents Note: Whilst every care has been taken to prepare these particulars, they are for guidance purposes only. All measurements are approximate and for general guidance purposes only and whilst every care has been taken to ensure accuracy, they should not be relied upon and potential buyers/tenants are advised to recheck the measurements.