



**HAIR & SON**  
THE ESTATE OFFICE

## London Road

Leigh-on-Sea, SS9 2SL

- TWO DOUBLE BEDROOMS
- GAS CENTRAL HEATING
- DOUBLE GLAZING
- OFF STREET PARKING

## £725 pcm

A purpose built first floor flat with two double bedrooms, uPVC double glazing and gas central heating. Car parking area. Communal gardens. Convenient for local shops and bus routes. RETIRED / MIDDLE AGED APPLICANTS ONLY.





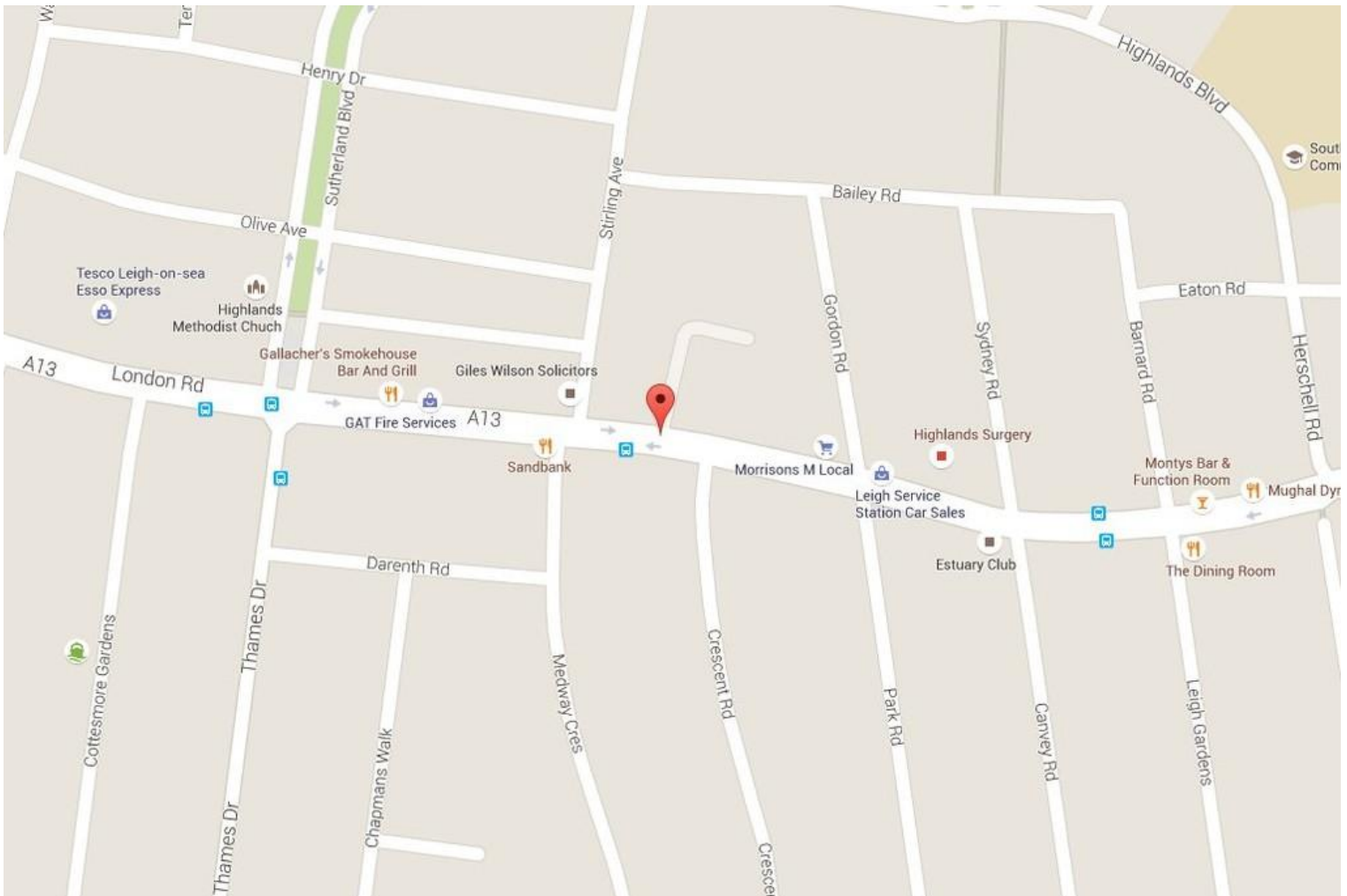

## ENTRANCE HALL

Accessed via communal entrance and stairs to first floor, the hall has a fitted storage cupboard, radiator and brown carpet.

## LOUNGE

The lounge is decorated in magnolia and has uPVC double glazed window overlooking the communal garden, radiator, brown carpet.

## KITCHEN

The kitchen is to the front of the flat and is partly tiled and fitted with modern units, it has a space for an electric cooker and washing machine plumbing. Gas combination boiler. Radiator. uPVC double-glazed window to front. Tile effect vinyl.

## BATHROOM

The bathroom has a white suite comprised of a panelled bath, pedestal wash hand basin and low flush WC. A uPVC double glazed window to front, electric wall heater and tile effect vinyl.

## BEDROOM 1

uPVC double glazed window to rear with radiator below, brown carpet.

## BEDROOM 2

uPVC double glazed window to front, radiator, brown carpet.

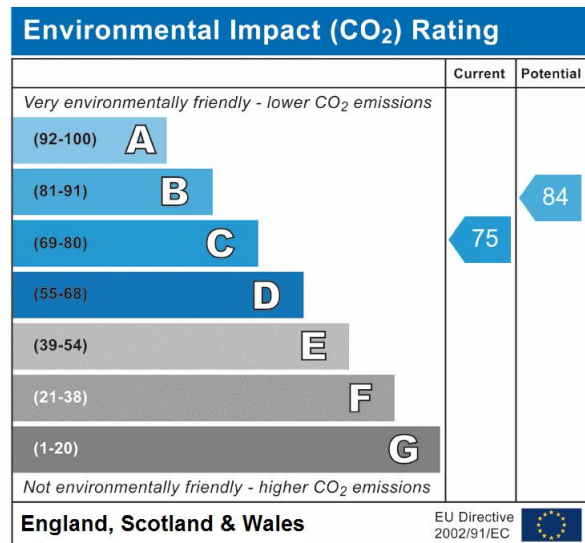
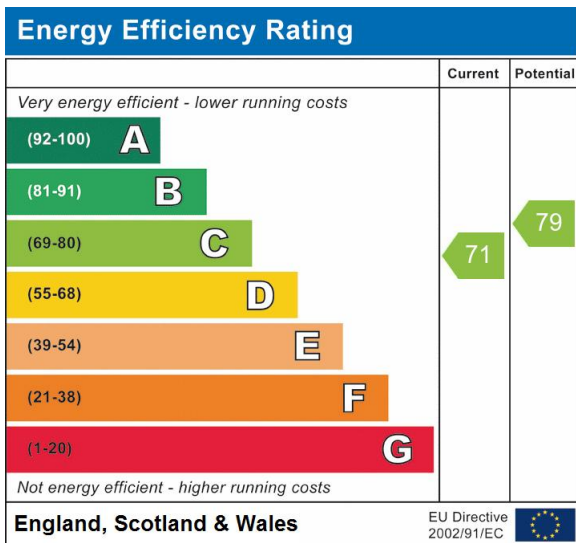

## First Floor

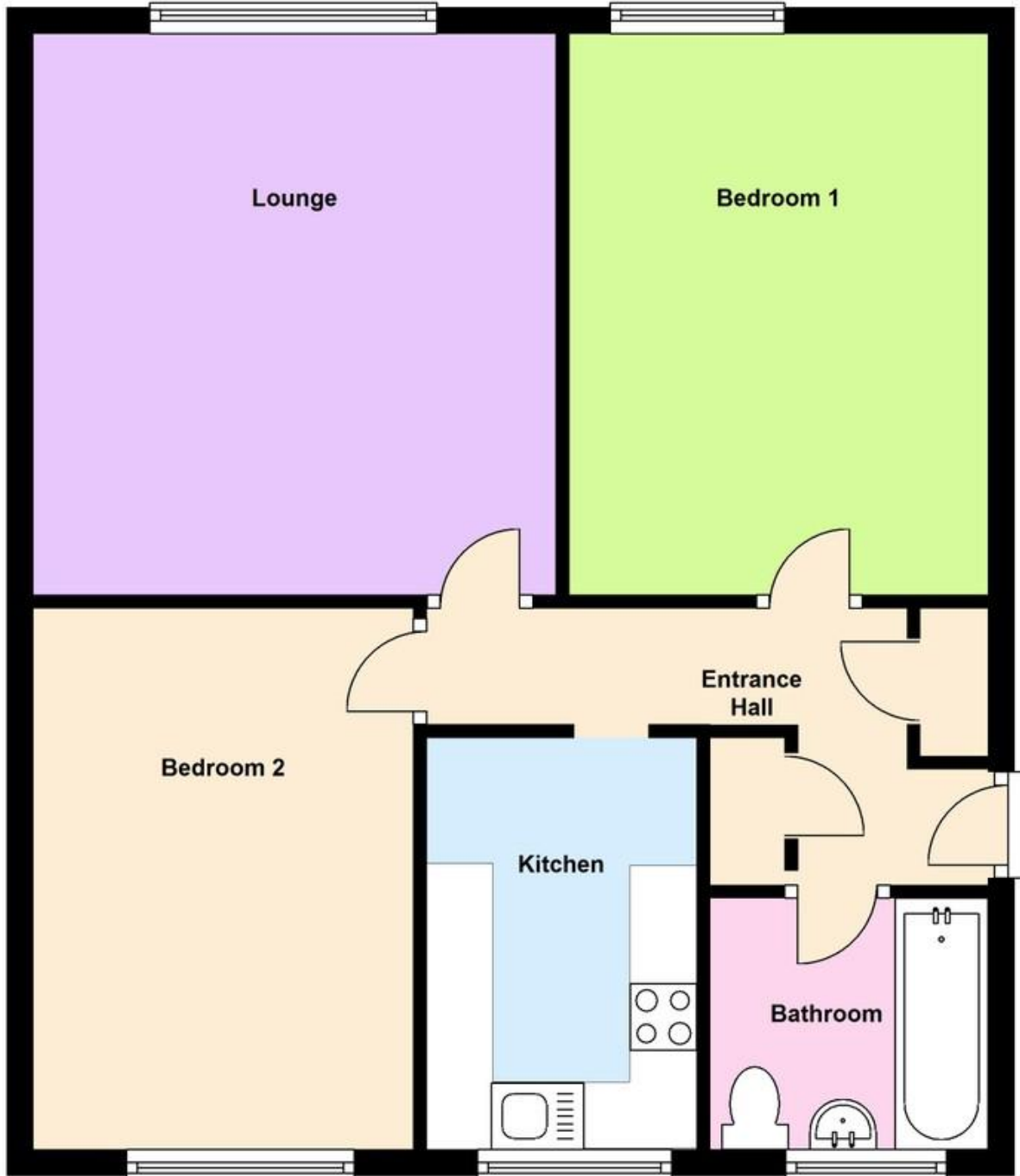

t. 01702 34 11 77

More than an estate agent

[www.hairandson.co.uk](http://www.hairandson.co.uk)

Residential Lettings

190 London Road

Southend-On-Sea

Essex

SS1 1PJ

