



RENT - £7,500 PAX (£625 PCM)

Hair and Son are delighted to bring to the market this first floor office suite located within the popular Business Centre located within Madeira Avenue, Leigh-On-Sea on the North side of London Road.

The centre offers offices suites on a fully serviced basis which includes, air conditioning (heating and cooling), 24/7 access, CCTV, electricity, WIFI

And Internet, meeting room (via booking system) communal kitchens and W/C located on both ground and first floors and parking to front on a first come, first serve basis.

AVAILABLE FOR IMMEDIATE VIEWING.

ACCOMMODATION

OFFICE: 12'6" X 19'6"

GROSS INTERNAL FLOOR AREA: 247 SQ.FT (23 SQ.M)

DESCRIPTION

Fully serviced first floor office suite to let.

RATEABLE VALUE

To be included within the rent.

ENERGY PERFORMANCE

The energy performance Certificate shows a rating of TBC

TERMS

To be let on a licence agreement for a minimum term of 12 months at a rent of £625 per calendar month (£7,500 per annum).

VIEWING

By prior telephone appointment via Hair and Son: 01702 394959 (Option 3).

Ground Floor

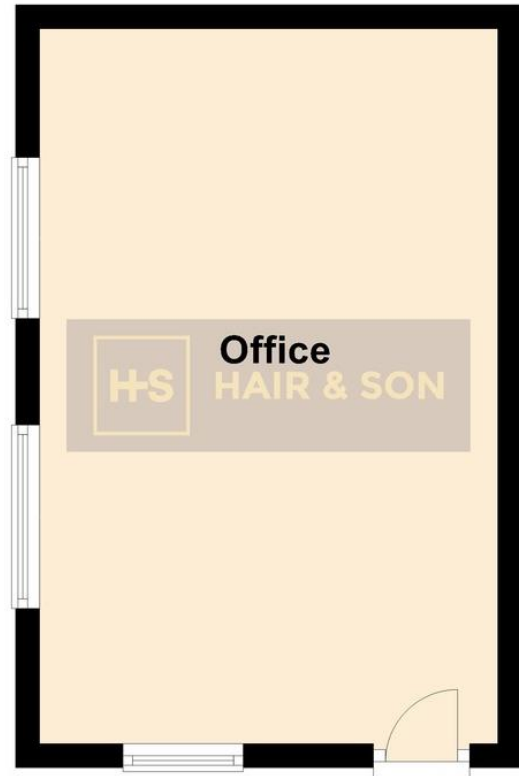

Suite 4, 8 Madeira Avenue

Hair & Son – 01702 394959 (Option 3)

www.hairandson.co.uk

These particulars are accurate to the best of our knowledge but do not constitute an offer or contract. Photos are for representation only and do not imply the inclusion of fixtures or fittings. The floorplans are not to scale and only provide an indication of the layout.

Regulated by RICS

t. 01702 394959 (Option 3)
More than an estate agent
www.hairandson.co.uk

Commercial Dept.
190 London Road
Southend-on-Sea,
Essex. SS1 1PJ

